



Check valve

CHV2 Series

Perfectly preventing reverse flow of compressed air, etc. Wide variation in 10 types

● Port size: Rc1/8 to Rc1 1/2

JIS symbol



Features

- **Wide variation**
Series are available for piping bore sizes Rc1/8 to Rc1 1/2.
- **Compact and lightweight**
The body has been downsized compared to CKD conventional parts, with an average volume of 34% and average mass of 25%.
- **Ample options**
Fluor rubber specifications and oil-prohibition specifications available as options. An installation bracket is available for small bore sizes.
- **Neat shape**
- **Eco-friendly product**
Products can be sorted and processed for recycling.

Specifications

Model no.	CHV2-6	CHV2-8-J	CHV2-8	CHV2-10-J	CHV2-10	CHV2-15	CHV2-20	CHV2-25	CHV2-32	CHV2-40
Working fluid	Compressed air									
Max. working pressure MPa	1									
Min. working pressure MPa	0.03									
Withstanding pressure MPa	1.5									
Cracking pressure MPa	0.02									
Fluid temperature °C	5 to 60									
Ambient temperature °C	0 to 60 (no freezing)									
Port size Rc	1/8	1/4		3/8		1/2	3/4	1	1 1/4	1 1/2
Product weight g	47		81		140		265		875	
Effective sectional area mm ²	28		55		60		94		110	

How to order

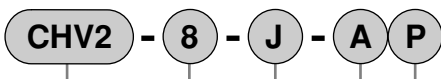

Symbol	Descriptions
A Port size	
6	Rc1/8
8	Rc1/4
10	Rc3/8
15	Rc1/2
20	Rc3/4
25	Rc1
32	Rc1 1/4
40	Rc1 1/2

B Option	
Blank	No option
A	Fluoro rubber specifications
P8	Oil-prohibited specifications

C Accessory	
Blank	None
P	Mounting plate attached

Note 1: Small flow compact type (J) is applicable only for port size Rc1/4 (8) and Rc3/8 (10).

Note 2: Options are indicated as alphabetic order. (AP8)

Note 3: Attachment of mounting plate is applicable for CHV2-6, CHV2-8-J, CHV2-8 and CHV2-10.

Operational principle

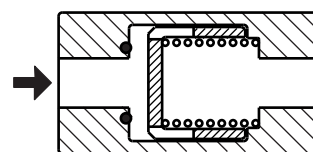

If pressurized from arrow → direction on the side body, the valve fully opens, and the flow turns to free flow.

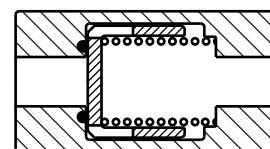

If pressurized from reverse direction of arrow → on the side body, the valve closes, and flow is interrupted.

Clean room specifications (catalog No. CB-033SA)

- Dust generation preventing structure for use in cleanrooms

CHV2 P7*

CHV2 P80

Internal structure and parts list

● CHV2-6, 8-J

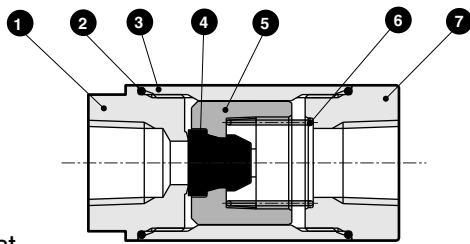

● CHV2-8 to 40

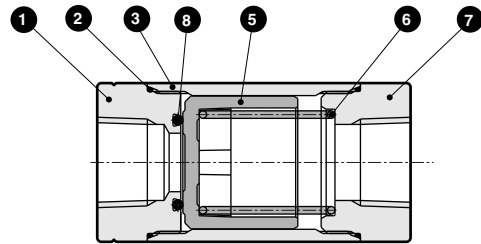

Parts list

No.	Parts name	Material	No.	Parts name	Material
1	Guard A	Aluminum alloy	5	Valve guide	Polyacetal
2	O ring	Nitrile rubber (fluoro rubber)	6	Coil spring	Stainless steel
3	Tube	Aluminum alloy	7	Guard B	Aluminum alloy
4	Valving element	Nitrile rubber (fluoro rubber)	8	O ring	Nitrile rubber (fluoro rubber)

* The material in () is for option "A" (fluorin rubber specification).

Dimensions

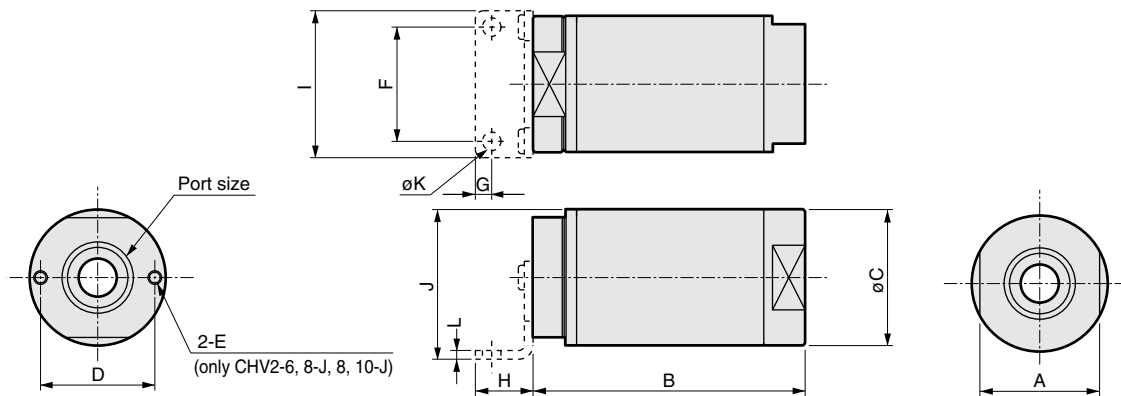

Dimensions table

Model no.	Port size	A	B	øC	D	E	F	G	H	I	J	øK	L
CHV2-6	Rc1/8	22	50	25	21	M2.5	21	3	10.5	27	27.5	3.4	1.6
CHV2-8-J	Rc1/4												
CHV2-8	Rc1/4	27	60	31	26	M3	25	5	14	32	34	4.4	
CHV2-10-J	Rc3/8												
CHV2-10	Rc3/8	32	75	38	-	-	-	-	-	-	-	-	
CHV2-15	Rc1/2												
CHV2-20	Rc3/4	42	95	47	-	-	-	-	-	-	-	-	
CHV2-25	Rc1												
CHV2-32	Rc1 1/4	63	140	72	-	-	-	-	-	-	-	-	
CHV2-40	Rc1 1/2												

! Safety Precautions

■ During Use & Maintenance

Installation of CHV2

- After temporarily tightening the mounting port by hand, tighten with the width across flats using a tool.

When connecting piping, tighten within the recommended tightening torque.

When removing piping from this product, use the width across flats of piping to be removed.

If the width across flats on the opposite side are used, the cover could loosen and lead to external leaks.

- Check JIS symbols on the product nameplate and pipe accordingly.

If pressure is applied from IN, fluid will flow freely. If pressure is applied from OUT, fluid will be shielded.

The side of the cover with a groove is IN, so check the direction when piping.

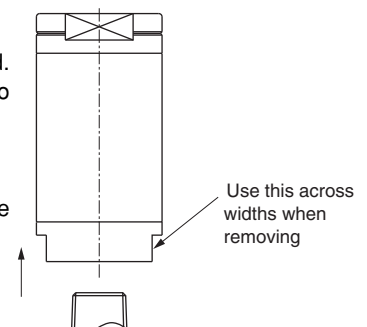

Refrigerating type dryer
Desiccant type dryer
High polymer membrane type dryer
Air filter
Auto. drain / others
F.R.L. (Module unit)
F.R.L. (Separate)
Compact F.R.
Precise regulator
F.R.L. (Related products)
Clean F.R.
Electro pneumatic regulator
Air booster
Speed control valve
Silencer
Check valve / others
Joint / tube
Vacuum filter
Vacuum regulator
Suction plate
Magnetic spring buffer
Mechanical pressure SW
Electronic pressure SW
Contact / close contact cont. SW
Air sensor
Pressure SW for coolant
Small flow sensor
Small flow controller
Flow sensor for air
Flow sensor for water
Total air system
Total air system (Gamma)

Ending

Check valve
Auxiliary valve