



Silencer Small bore size type resin body type

SL/SLW Series

Damping effect 30dB (A) and over

● Port size: M5, R1/8 to R1/2

JIS symbol

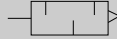

Specifications

Descriptions	SL-M5	SLW-6A SLW-6N	SLW-8A SLW-8N	SLW-10A SLW-10N	SLW-15A SLW-15N
Working fluid	Compressed air				
Max. working pressure MPa	1.0				
Min. working pressure MPa	0				
Withstanding pressure MPa	1.5				
Fluid temperature °C	5 to 60 (no freezing Note2)				
Ambient temperature °C	-10 to 60 (no freezing)				
Port size R/NPT/G	M5	1/8	1/4	3/8	1/2
Product weight g	5	3.5	7.5	15	21
Applicable cylinder bore size mm	ø6 to ø15	ø20 to ø80	ø32 to ø80	ø50 to ø100	ø50 to ø100
Damping effect dB	20 and over	30 and over			
Flow Note1 ℓ/min. (ANR)	300	650	1300	2000	4850
Effective sectional area mm ²	5	10	20	30	75

Note 1: Flow rate is the atmospheric pressure conversion value at pressure 0.5MPa.

Note 2: Freezing could occur by adiabatic expansion depending on air quality (dew point).

How to order

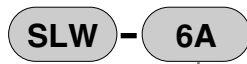
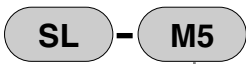

A Port size	
M5	M5 × 0.8

Note: Sales unit is 2 pcs/bag.

A Port size	
6A	R1/8
6N	NPT1/8
6G	G1/8
8A	R1/4
8N	NPT1/4
8G	G1/4
10A	R3/8
10N	NPT3/8
10G	G3/8
15A	R1/2
15N	NPT1/2
15G	G1/2

Internal structure and parts list / dimensions

● SL-M5

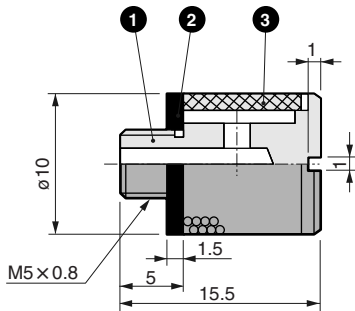

No.	Parts name	Material
1	Body	Brass
2	Gasket	Nitrile rubber
3	Element	Brass sintering

● SLW-6A/8A/10A/15A

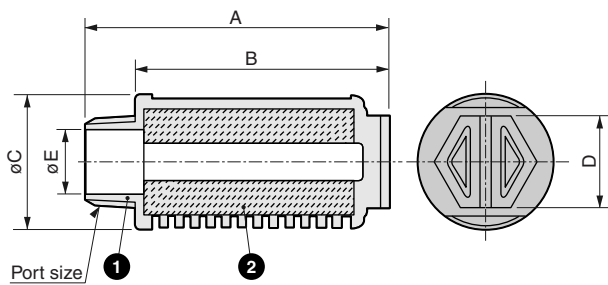

No.	Parts name	Material	Color
1	Body	Polyamide resin (flame resistant resin *)	White
2	Element	PP sintering resin	White

* Equivalent to UL94 standards V-O

Model no.	A	B	C	D	E	Port size	
						A	N
SLW-6*	34	28	16.5	10	7	R1/8	NPT1/8
SLW-8*	44.5	36	20	13	8.5	R1/4	NPT1/4
SLW-10*	58.5	48.5	25.5	17	12	R3/8	NPT3/8
SLW-15*	71.4	58.4	28	19	15	R1/2	NPT1/2

Safety Precautions

- Use tightening torque as strong as human hand. (Refer to the table below for tightening torque.)

Thread size	Tightening torque (N·m)
M5	1.0
R1/8	1.0
R1/4	2.5
R3/8	3.0
R1/2	3.0

- Refrigerating type dryer
- Desiccant type dryer
- High polymer membrane type dryer
- Air filter
- Auto. drain / others
- F.R.L. (Module unit)
- F.R.L. (Separate)
- Compact F.R.
- Precise regulator
- F.R.L. (Related products)
- Clean F.R.
- Electro pneumatic regulator
- Air booster
- Speed control valve
- Silencer**
- Check valve / others
- Joint / tube**
- Vacuum filter
- Vacuum regulator
- Suction plate
- Magnetic spring buffer
- Mechanical pressure SW
- Electronic pressure SW
- Contact / close contact cont. SW
- Air sensor
- Pressure SW for coolant
- Small flow sensor
- Small flow controller
- Flow sensor for air
- Flow sensor for water
- Total air system
- Total air system (Gamma)

Ending

Small bore size / resin body type
Silencer