

Data sheet

Float switch brass design 1

Type: SSM...1...

Device with temperature sensor or temperature switch combinable, see also level / temperature measurement technology combined

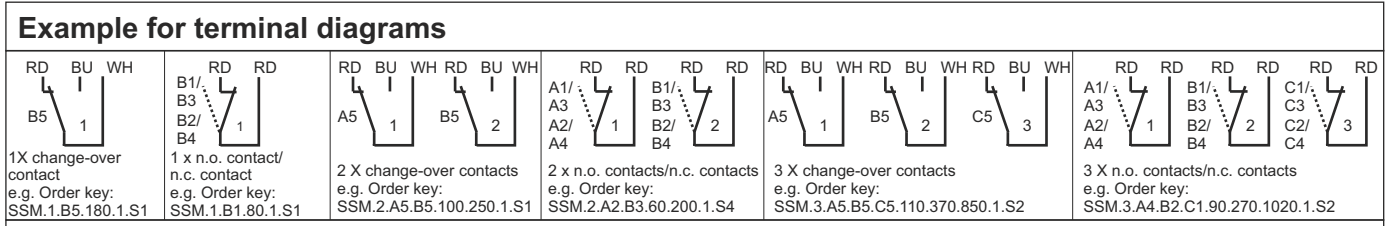
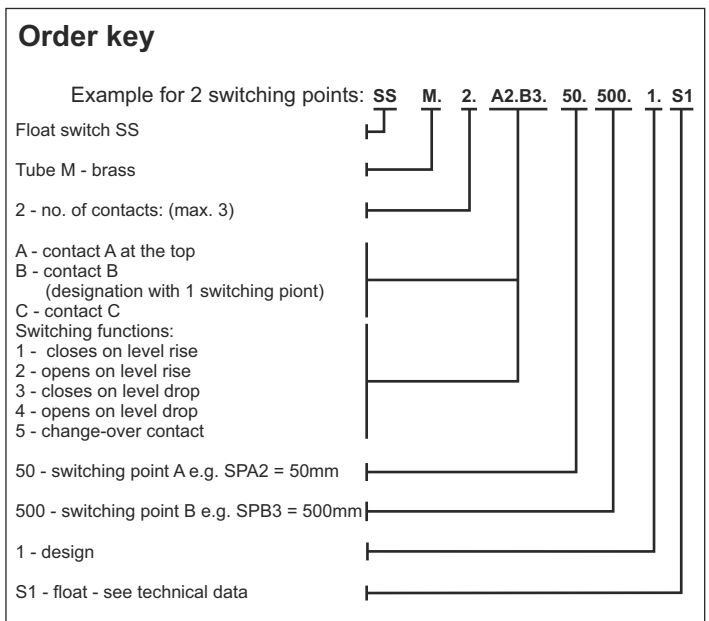
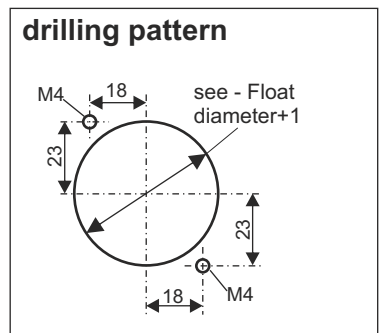
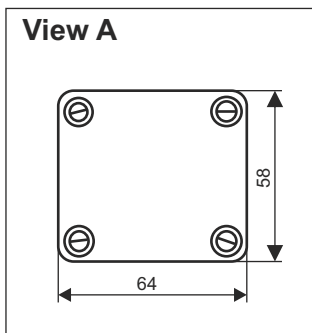
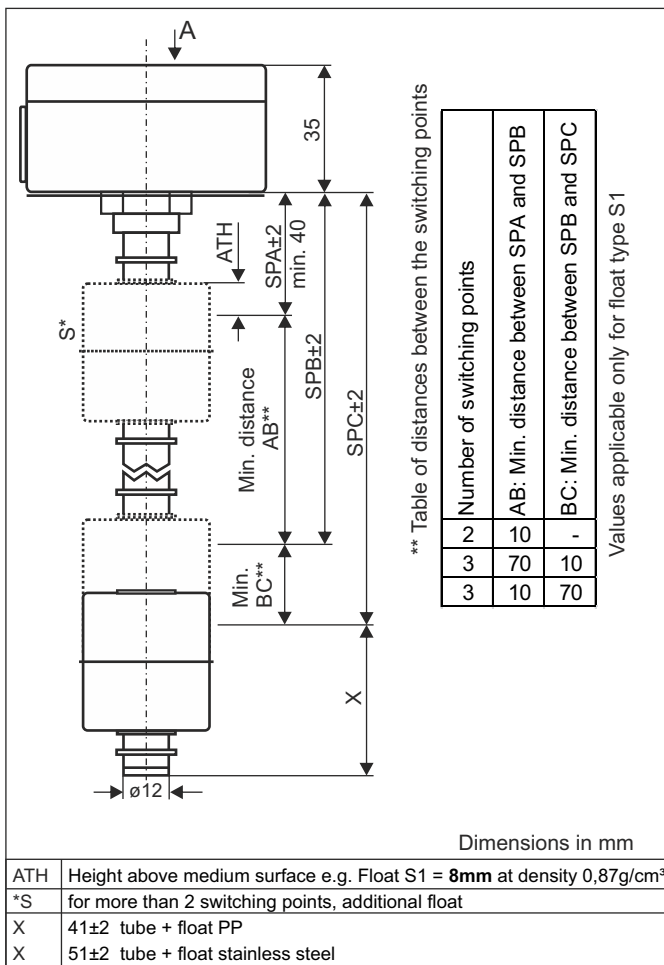

Technical data

Connection:	terminal connection 1,5mm ² in the housing cable entry at the housing M16x1,5 housing material alu, colour grey
Mounting	via housing floor - see drilling pattern
Seal:	material NBR
Tube:	ø12mm, material brass
Float:	S1: material PP ø35x40mm S2: material PP ø40x40mm S3: material PP ø40x30mm S4: material stainless steel 1.4571 ø45x52mm
Switching points:	reed contacts, max. 3 x n.o. contact/n.c. contact or changeover contact additional reed contacts available on request
Switching voltage, current, output:	230 VAC, 1A, 60VA
Pressure:	max. 1 bar
Operating temperature:	-20°C to 80°C in medium, -20°C to 70°C above mounting
Protection rating:	IP 65

Data sheet

Float switch brass design 2

Type: SSM...2...

Device with temperature sensor or temperature switch combinable,
see also level / temperature measurement technology combined

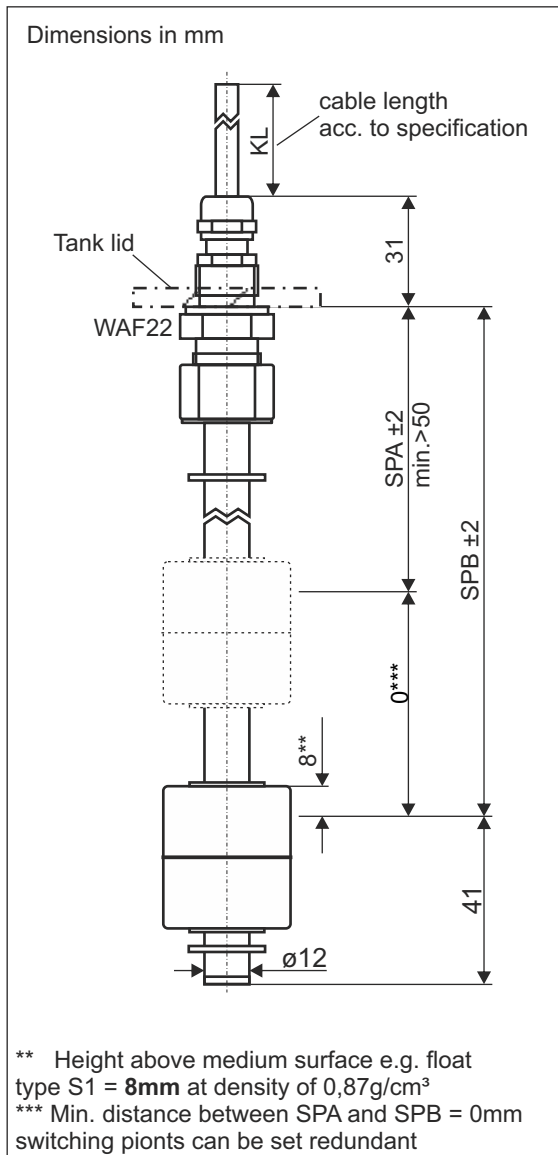

Order key

Example for 2 switching points: **SS M. 2. A2.B3. 50. 500. 2. S1. KL1000**

Float switch SS

Tube M - brass

2 - no. of contacts (max. 2)

A - contact A at the top

B - contact B

(designation with 1 contact)

Switching functions:

1 - closes on level rise

2 - opens on level rise

3 - closes on level drop

4 - opens on level drop

5 - change-over contact

50 - switching point A e.g. SPA2 = 50mm

500 - switching point B e.g. SPB3 = 500mm

2 - design

S1 - float - see technical data

KL - cable length 1000mm

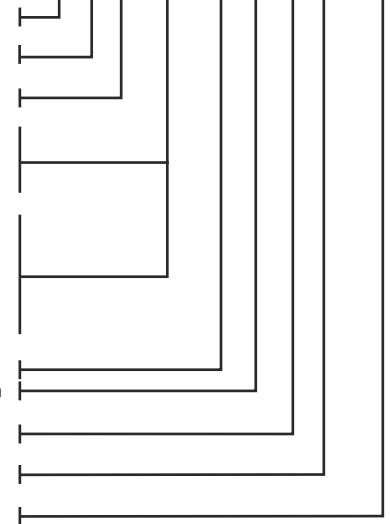

Terminal diagrams

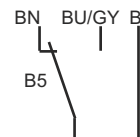

1 x change-over contact;
e.g.: SSM.2.B5.50.2.S1

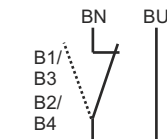

1 x n.o. contact/n.c. contact;
e.g.: SSM.2.B3.50.2.S1

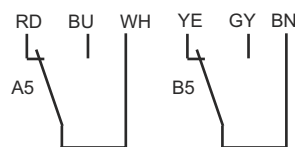

2 x change-over contact;
e.g.: SSM.2.A5.B5.50.500.2.S1

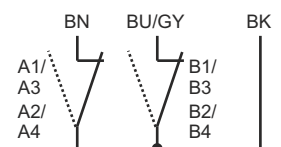

2 x n.o. contacts/n.c. contacts;
e.g.: SSM.2.A2.B3.50.500.2.S1

Technical Data

Connetion:	Standard: oil-resistant cable, length KL 1000mm; other cable types and lengths acc. to customer specification. cable entry via cable gland, material brass
Mounting:	thread R3/8", material brass
Tube:	ø12mm, length L±1mm according to specification, material brass
Float:	S1: ø35x40mm, material PP S2: ø40x40mm, material PP S3: ø40x30mm, material PP S4: ø45x52mm, material stainless steel 1.4571
Switching points:	reed contacts: max. 2x n.o. contacts/n.c. contacts or change-over contacts
Switching capacity:	max. 24 VDC / 150mA
Pressure:	max. 1 bar
Operating temperature:	-20°C to 80°C in medium, -20°C to 70°C above mounting.
Protection rating:	IP 65

Data sheet

Float switch brass design 3 with conduit

Type: SSM...3...

Device with temperature sensor or temperature switch combinable, see also level / temperature measurement technology combined

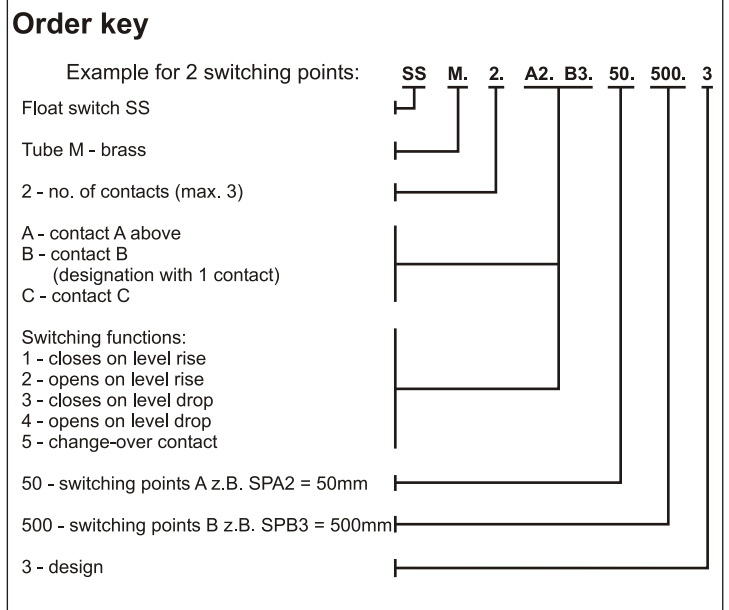
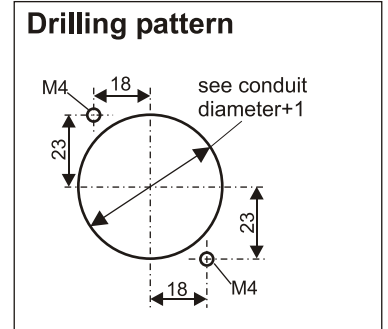
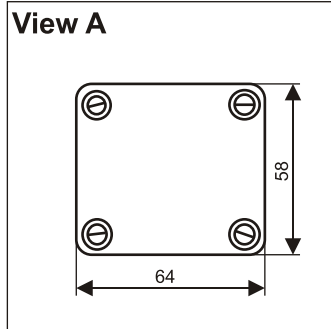
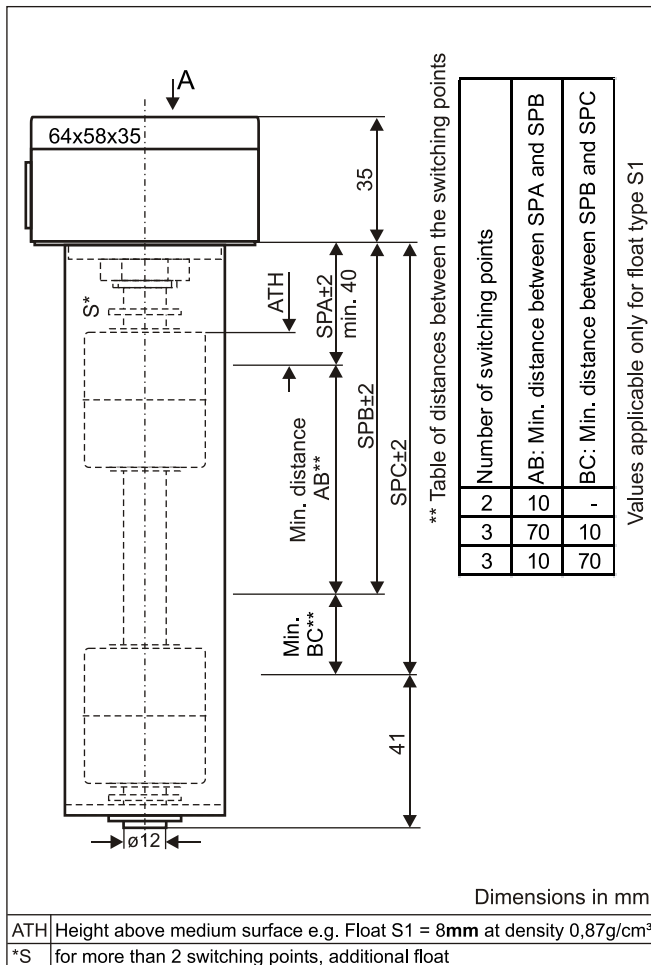

Example for terminal diagrams

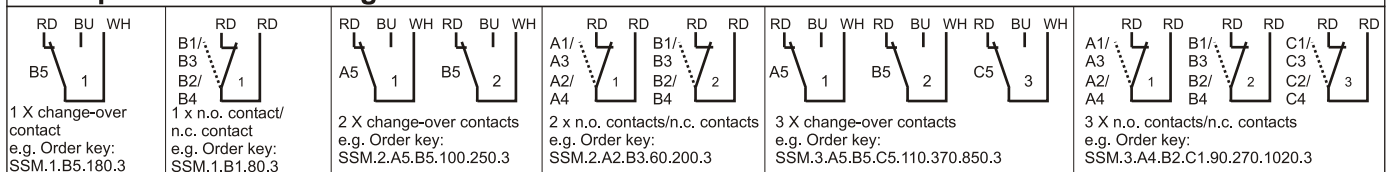

Technical data

Connection:	terminal connection 1,5mm ² in the housing cable entry at the housing M16x1,5
Mounting:	aluminium die-cast housing, colour grey via housing floor - see drilling pattern
Seal:	material NBR
Tube:	ø12mm, material brass
Conduit:	ø45mm, material brass
Float:	ø35x40mm, material PP, type S1
Switching points:	reed contacts, max. 3x n.o. contacts/n.c. contacts or change-over contacts, further reed contacts on demand
Switching voltage, current, output:	230 VAC, 1A, 60VA
Pressure:	max. 1 bar
Operating temperature:	-20°C to 80°C in medium, -20°C to 70°C above mounting
Protection rating:	IP 65

Data sheet

Float switch brass design 5

Type: SSM...5...

Device with temperature sensor or temperature switch combinable,
see also level / temperature measurement technology combined

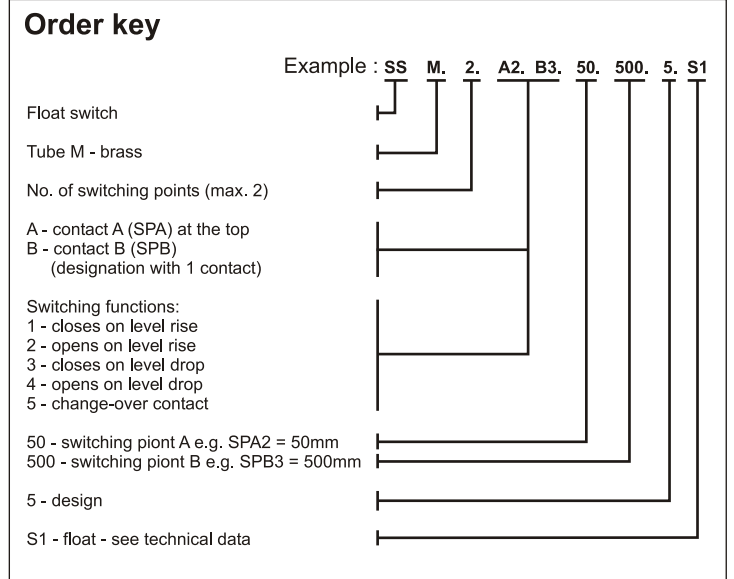
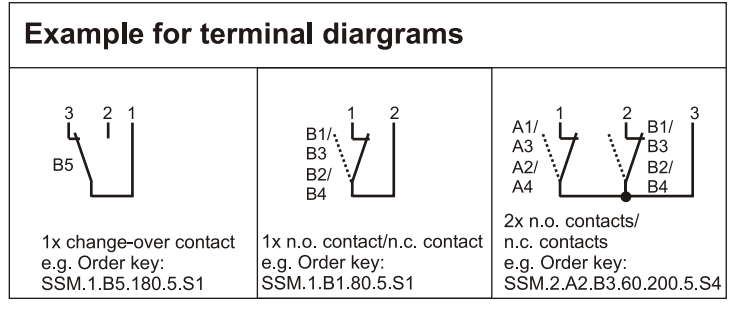
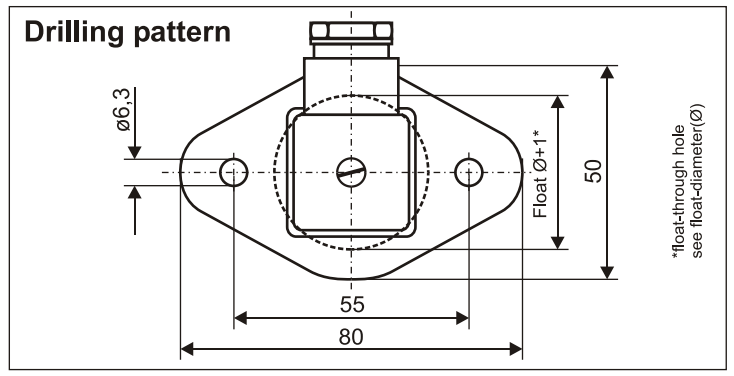
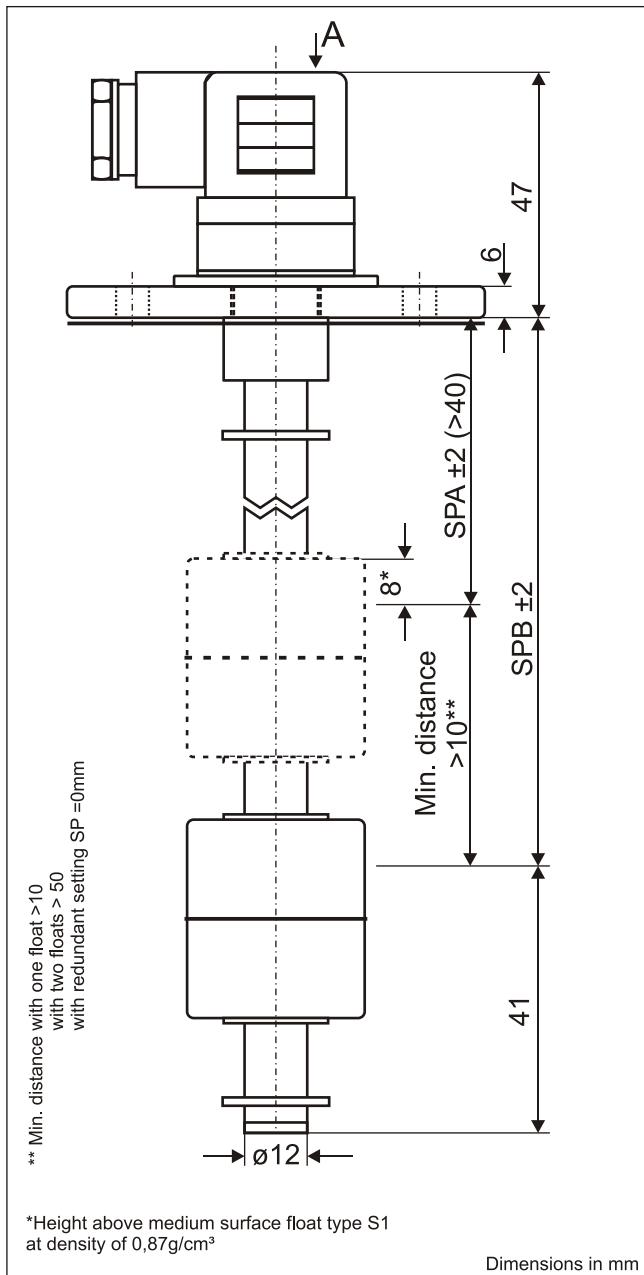

Technical data

Connection:	plug-type connector 3 pole + PE, DIN EN 175301-803 (DIN 43650), material PA,
Mounting:	oval flange 80x50mm, material PA
Seal:	material NBR
Tube:	Ø12mm, material brass, length ±1mm acc. to customer specification
Float:	Ø35x40mm, material PP, type S1
Switching points:	reed contacts: max. 2x n.o. contacts / n.c. contacts or 1x change-over contact,
Switching voltage, current, output:	230 VAC, 1A, 60VA
Pressure:	atmospheric
Operating temperature:	-20°C to 80°C in medium; -20°C to 70°C above mounting
Protection rating:	IP 65

Data sheet

Float switch brass design 7

Type: SSM....7....

Device with temperature sensor or temperature switch combinable,
see also level / temperature measurement technology combined

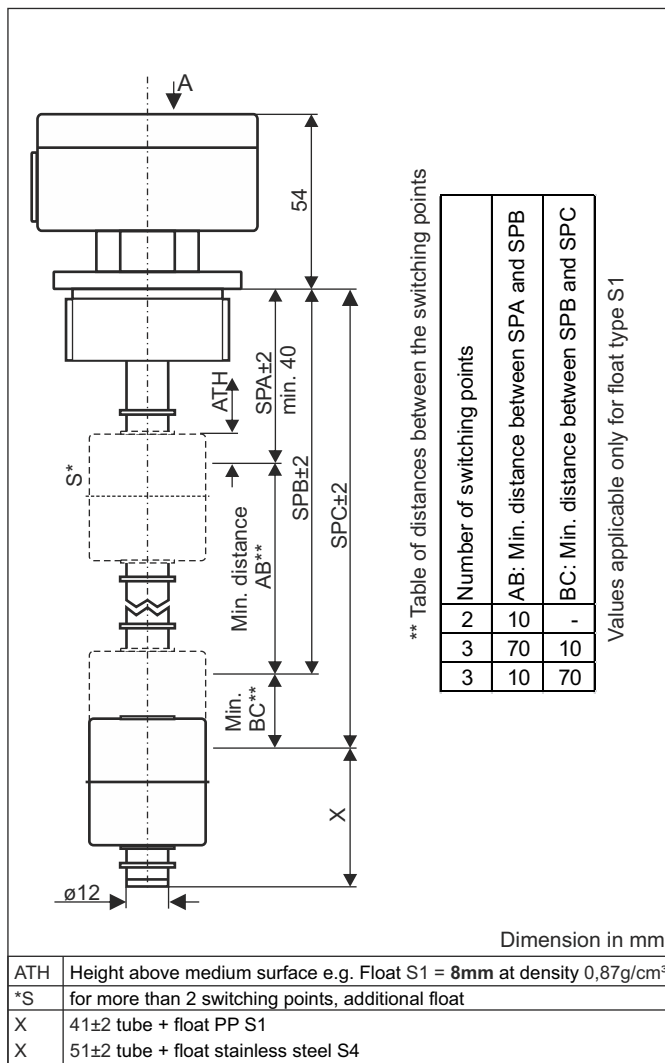

View A

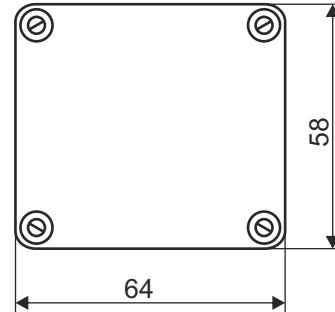

Order key

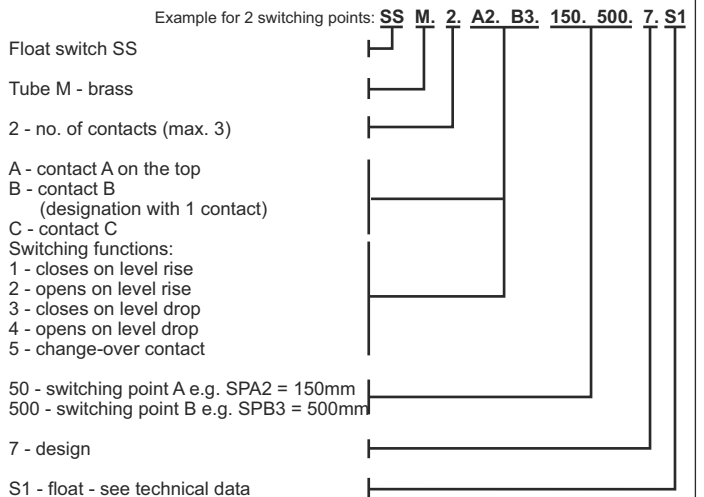

Example for terminal diagrams

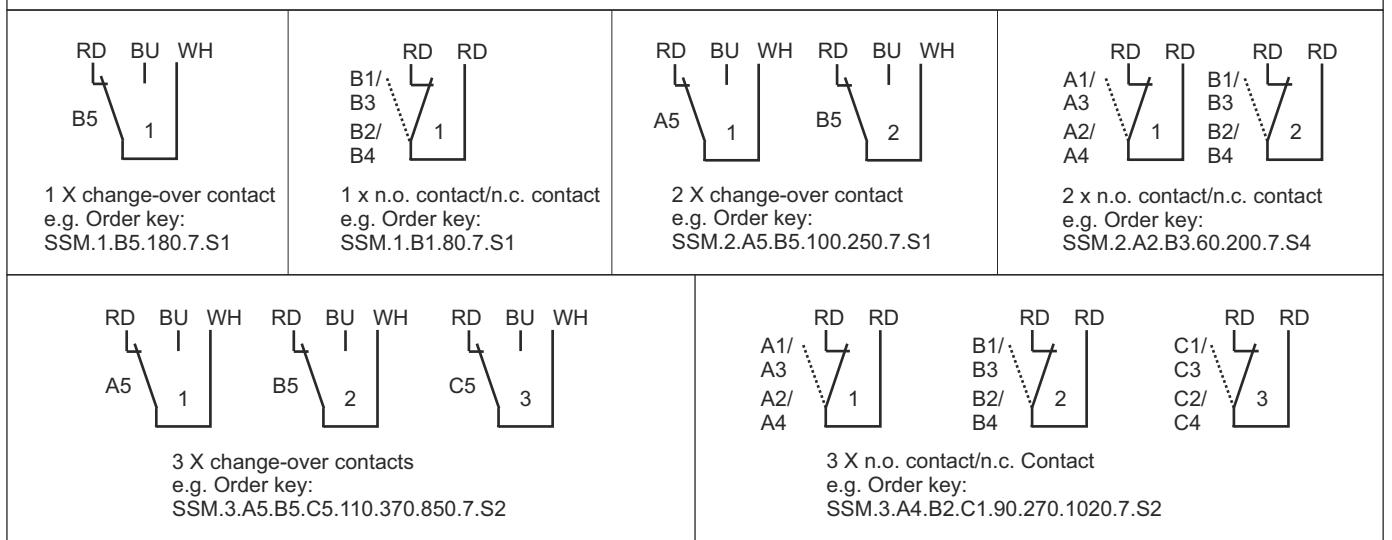

Data sheet

Float switch brass design 7

Type: SSM....7....

Technical Data

Connction:	terminal connection 1,5mm ² in the housing cable entry at the housing M16x1,5, material alu, colour grey
Mounting:	1 1/2" thread, material alu
Tube:	ø12mm, material brass
Float:	ø35x40mm, material PP, type S1 ø40x40mm, material PP, type S2 ø40x30mm, material PP, type S3 ø45x52mm, material stainless steel 1.4571, type S4
Switching points:	reed contacts, max. 3x n.o. contact/n.c. contact or change-over contact, additional reed contacts available on request
Switching voltage:	max. 230 VAC
Switching current:	1A
Switching capacity:	60VA
Pressure:	max. 1 bar
Operating temperature:	-20°C to 80°C in medium, -20°C to 70°C above mounting
Protection rating:	IP 65

Data sheet

Float switch brass design 10

Type: SSM...10...

Device with temperature sensor or temperature switch combinable,
see also level / temperature measurement technology combined

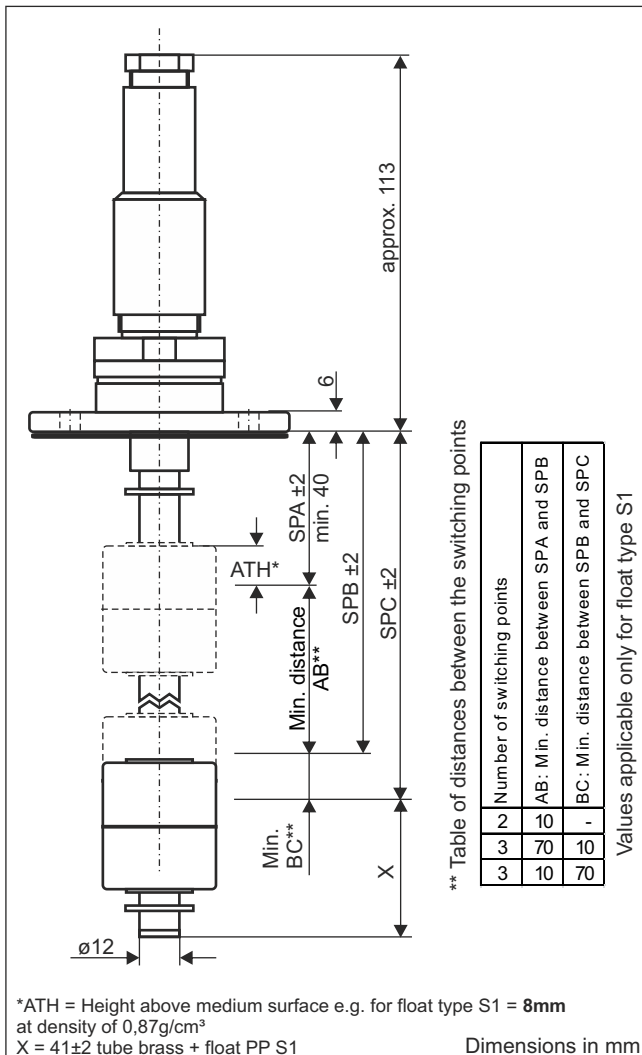

Drilling pattern

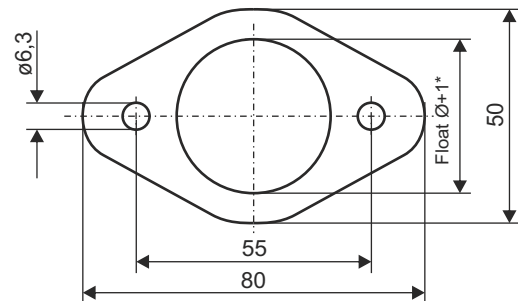

*float-through hole
see float-diameter (Ø)

Order key

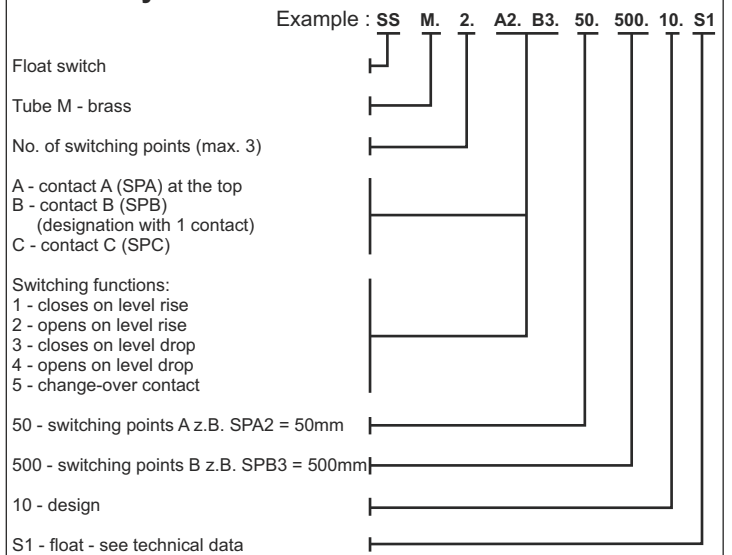

Examples for terminal diagrams

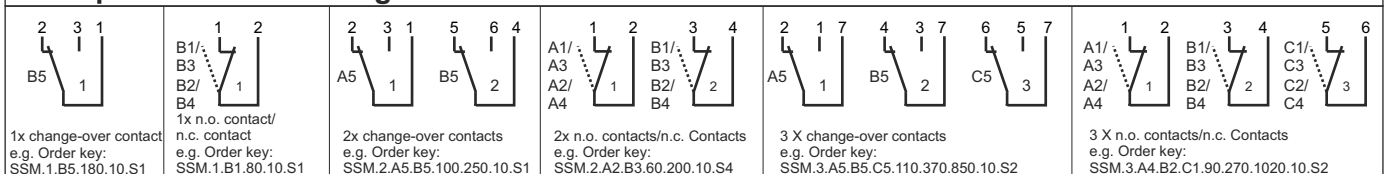

Technical data

Connection:	plug-type connector 7-pole + PE acc. to DIN EN 175201-804 (DIN 43651), material PA,
Mounting:	oval flange 80x50mm, material PA
Seal:	material NBR
Tube:	ø12mm, material brass
Float:	ø35x40mm, material PP, type S1 ø40x40mm, material PP, type S2 ø40x30mm, material PP, type S3 ø45x52mm, material stainless steel 1.4571, type S4
Switching points:	reed contacts, max. 3x n.o. contacts/ n.c. contacts or change-over contacts further reed contacts on demand
Switching voltage, current, output:	230 VAC, 1A, 60VA
Pressure:	atmospheric
Operating temperature:	-20°C to 80°C in medium; -20°C to 70°C above mounting
Protection rating:	IP 65

Data sheet

Float switch brass design 21

Type: SSM...21...

Device with temperature sensor or temperature switch combinable,
see also level / temperature measurement technology combined

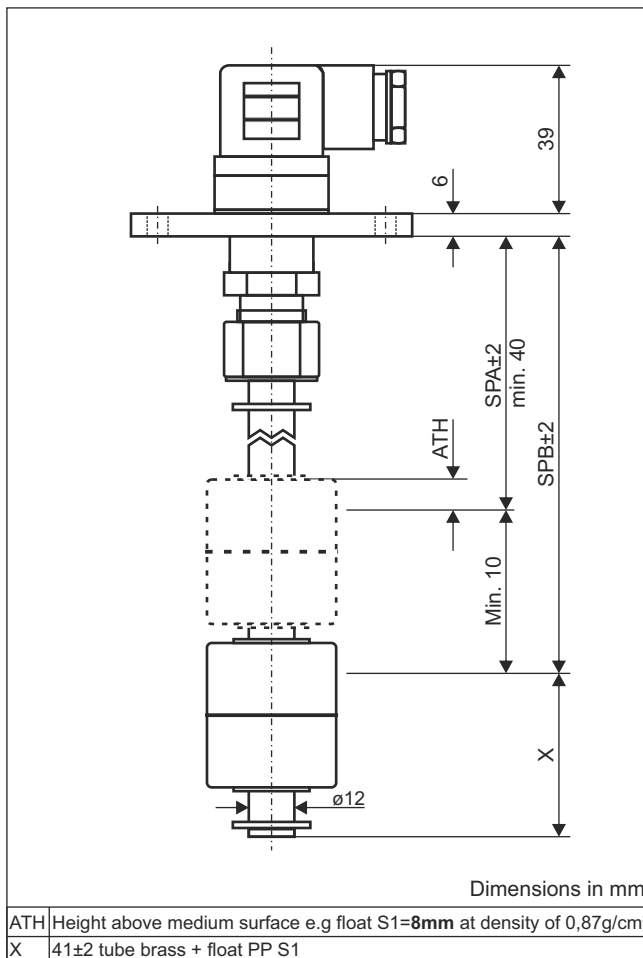

Drilling pattern

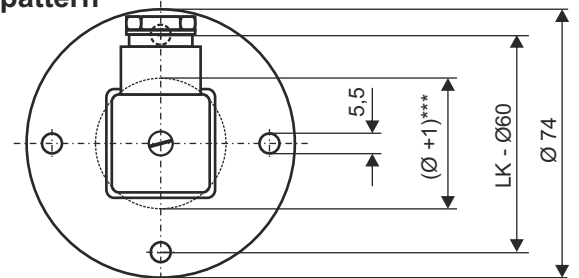

***float through hole, see float-diameter Ø

Order key

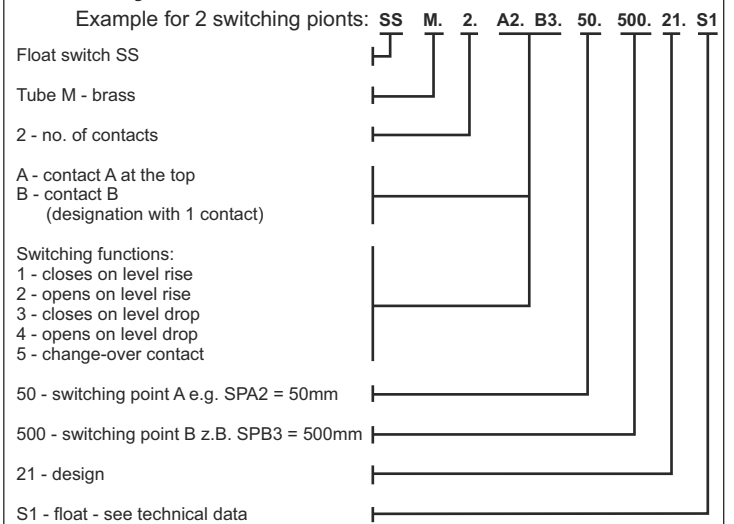

Example for terminal diagrams

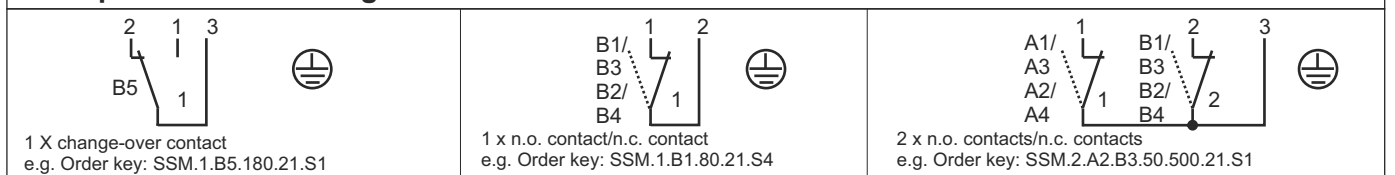

Technical data

Connection:	right-angled plug-type connector 3-pole + PE, DIN EN 175301-803 (DIN 43650), material PA
Mounting:	flange Ø74mm, material alu
Seal:	material NBR
Tube:	Ø12mm, material brass
Float:	Ø35x40mm, material PP, type S1 Ø40x40mm, material PP, type S2 Ø40x30mm, material PP, type S3 Ø45x52mm, material stainless steel 1.4571, type S4
Switching points:	reed contacte, max. 2x n.o. contacts/ n.c. contacts or 1x change-over contact,
Switching capacity:	230 VAC / 1A / 60VA or 100VDC / 1A / 60W
Pressure:	max. 1 bar
Operating temperature:	-20°C to 80°C in medium, -20°C to 70°C above mounting
Protection rating:	IP 65

Data sheet

Float switch brass design 26

Type: SSM...26...

Device with temperature sensor or temperature switch combinable,
see also level / temperature measurement technology combined

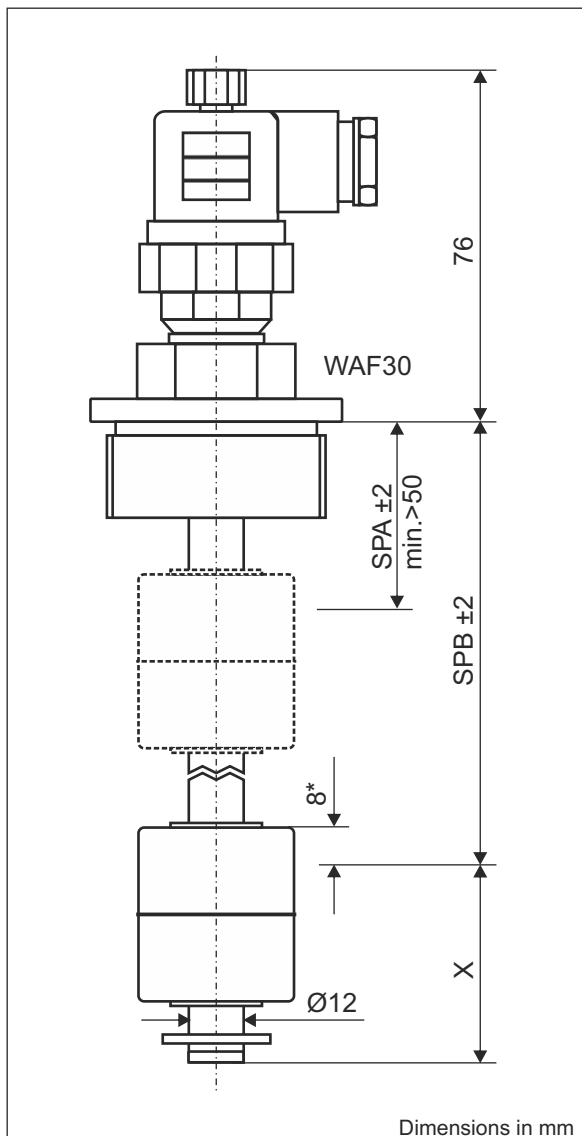

Dimensions in mm

ATH	Height above medium surface e.g. float S1 = 8mm at density of 0,87g/cm ³
*S	for more than 2 switching points, additional floats
X	41±2 tube stainless steel + float PP
X	51±2 tube stainless steel + float stainless steel

Terminal diagram

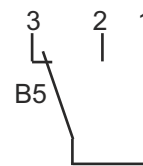

1 x change-over contact;
e.g.: SSM.2.B5.50.2.S1
230VAC/1A/60 VA

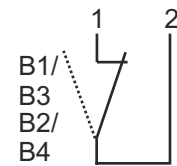

1 x n.c. contact/n.o. contact;
e.g.: SSM.2.B3.50.2.S1
230VAC/1A/60 VA

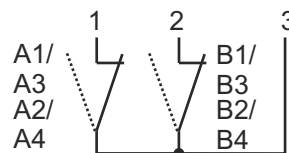

2 x n.c. contact/n.o. contact;
e.g.: SSM.2.A2.B3.50.500.2.S1
230VAC/1A/60 VA

Order key

Example for 2 switching points: **SS M. 2. A2. B3. 50. 500. 26. S1**

Float switch SS

Tube M - brass

2 - No of switching points (max. 2)

A - switching point A above

B - switching point B

(designation with 1 contact)

Switching functions:

1 - closes on level rise

2 - opens on level rise

3 - closes on level drop

4 - opens on level drop

5 - change-over contact

50 - switching point A e.g. SPA2 = 50mm

500 - switching point B e.g. SPB3 = 500mm

26 - design

S1 - float - see technical data

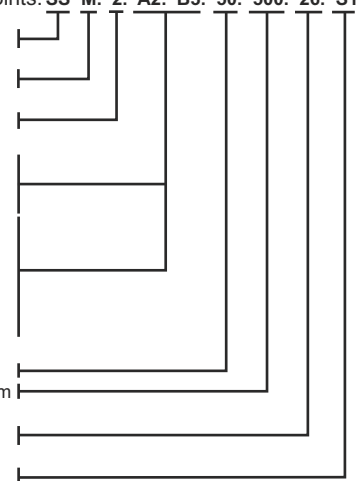

Technical data

Connection:	right-angled connector 3-pole + PE DIN EN 175301-803 (DIN 43650), material PA
Mounting:	thread 1 1/2", material alu
Tube:	Ø12mm, material brass
Float:	<ul style="list-style-type: none"> ø35x40mm, material PP, type S1 ø40x40mm, material PP, type S2 ø40x30mm, material PP, type S3 ø45x52mm, material stainless steel 1.4571, type S4
Switching points:	reed contacts: max. 2x normally open contact / normally closed contact or 1x change-over contact
Switching capacity:	max. 230 VAC / 1A / 60VA
Pressure:	max. 1 bar
Operating temperature:	-20°C to 80°C in medium, -20°C to 70°C above mounting
Protection rating:	IP 65

Data sheet

Float switch brass design 45

Type: SSM...45...

Device with temperature sensor or temperature switch combinable,
see also level / temperature measurement technology combined

* Height above medium surface for e.g. float type S1 at density of 0,87g/cm³

Dimensions in mm

Drilling pattern

*Float-through hole see float-diameter (Ø)

Terminal diagram

Order key

Example for 2 switching points: **SS M. 2. A3. B4. 50. 500. 45. S1**

Float switch SS	┌───┐	┌───┐	┌───┐	┌───┐	┌───┐	┌───┐	┌───┐	┌───┐	┌───┐	┌───┐
Tube M - brass	┌───┐	┌───┐	┌───┐	┌───┐	┌───┐	┌───┐	┌───┐	┌───┐	┌───┐	┌───┐
2 - no. of contacts (max. 2)	┌───┐	┌───┐	┌───┐	┌───┐	┌───┐	┌───┐	┌───┐	┌───┐	┌───┐	┌───┐
A - contact A above B - contact B (designation with 1 contact)	┌───┐	┌───┐	┌───┐	┌───┐	┌───┐	┌───┐	┌───┐	┌───┐	┌───┐	┌───┐
Switching functions: 1 - closes on level rise 2 - opens on level rise 3 - closes on level drop 4 - opens on level drop 5 - change-over contact	┌───┐	┌───┐	┌───┐	┌───┐	┌───┐	┌───┐	┌───┐	┌───┐	┌───┐	┌───┐
50 - switching point A e.g. SPA3 = 50mm	┌───┐	┌───┐	┌───┐	┌───┐	┌───┐	┌───┐	┌───┐	┌───┐	┌───┐	┌───┐
500 - switching point B e.g. SPB4 = 500mm	┌───┐	┌───┐	┌───┐	┌───┐	┌───┐	┌───┐	┌───┐	┌───┐	┌───┐	┌───┐
45 - design	┌───┐	┌───┐	┌───┐	┌───┐	┌───┐	┌───┐	┌───┐	┌───┐	┌───┐	┌───┐
S1 - float switch - see technical data	┌───┐	┌───┐	┌───┐	┌───┐	┌───┐	┌───┐	┌───┐	┌───┐	┌───┐	┌───┐

Technical data

Connetion:	plug-type connector M12x1 4-pole/5-pole depending on number and type, with connector socket, material PA
Mounting:	oval flange 80x50mm, material PA
Seal:	material NBR
Tube:	ø12mm, material brass
Float:	ø35x40mm, material PP, type S1 ø40x40mm, material PP, type S2 ø40x30mm, material PP, type S3 ø45x52mm, material stainless steel 1.4571, type S4
Switching pionts:	reed contacts, max. 2x n.o. contacts/n.c. contacts or 1x change-over contact, further reed contacts on demand
Switching capacity:	24VDC / 150mA
Pressure:	atmospheric
Operating temperature:	-20°C to 80°C in medium, -20°C to 70°C above mounting
Protection rating:	IP 65

Data sheet

Float switch brass design 81

Type: SSM...81...

Device with temperature sensor or temperature switch combinable,
see also level / temperature measurement technology combined

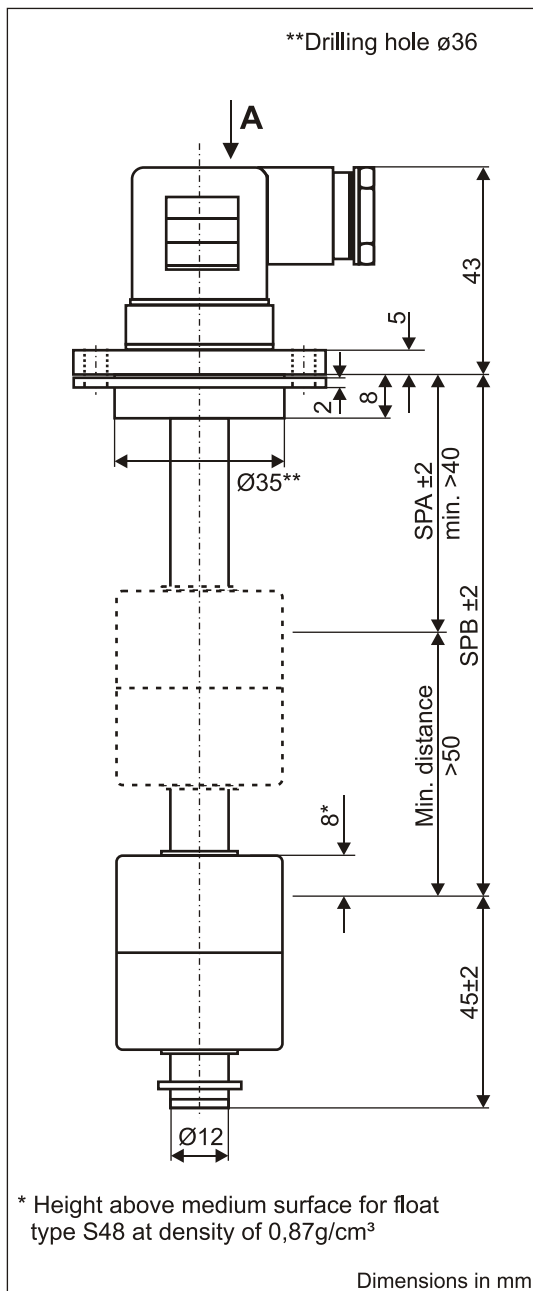

View A

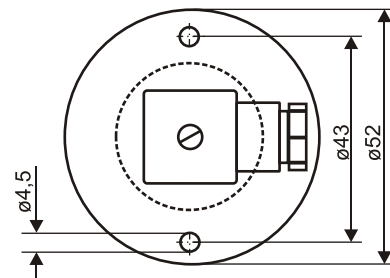

Terminal diagrams

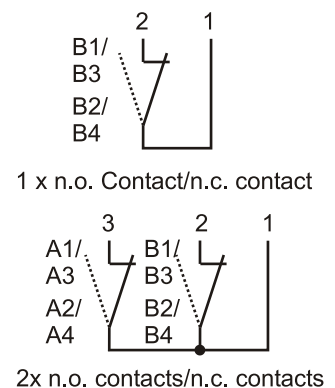
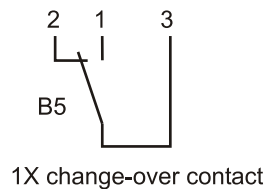

Order key

Float switch

Tube M - brass

No. of switching points (max. 2)

A - contact A (SPA) above
B - contact B (SPB)
(designation with 1 contact)

Switching functions:
1 - closes on level rise
2 - opens on level rise
3 - closes on level drop
4 - opens on level drop
5 - change-over contact

100 - switching point SPA e.g. 100mm
200 - switching point SPB e.g. 200mm

81 - design

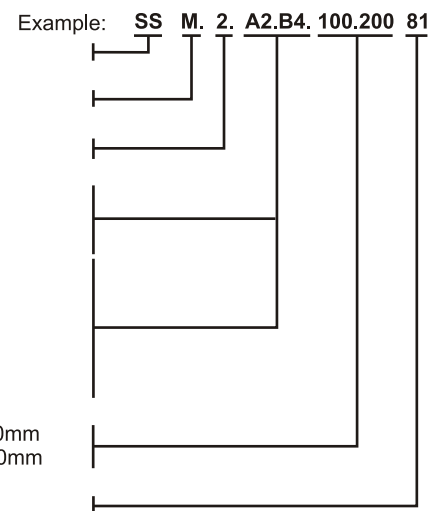

Technical data

Connection:	plug-type connector 3-pole acc. to DIN EN 175301-803 (DIN 43650), material PA
Mounting:	round flange, OD Ø52mm, height 13mm, material aluminium
Seal:	material NBR
Tube:	Ø12mm, material brass
Float:	Ø35x40mm, material PP, type S48
Switching points:	reed contact, max. 1x change-over contact, 2x n.o contacts / n.c. contacts
Switching voltage:	max. 230 VAC
Switching current:	1A
Switching capacity:	60 VA
Pressure:	1 bar
Operating temperature:	-20°C to 80°C in medium; -20°C to 70°C above mounting
Protection rating:	IP 65

Data sheet

Float switch brass design 108

Type: SSM...108...

Device with temperature sensor or temperature switch combinable,
see also level / temperature measurement technology combined

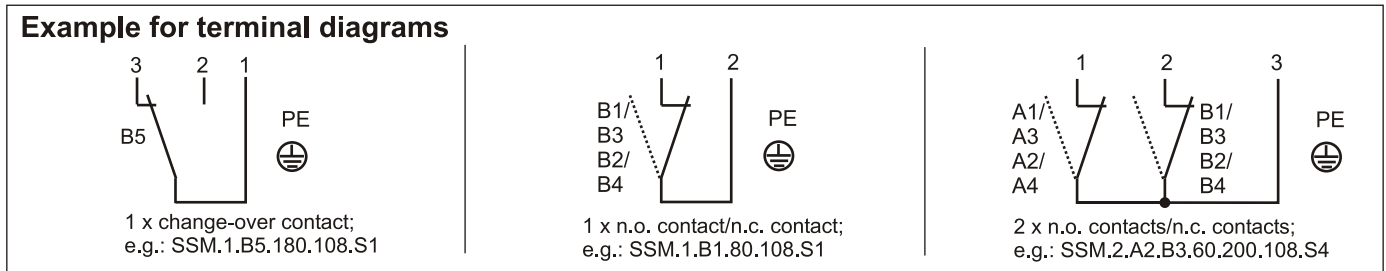
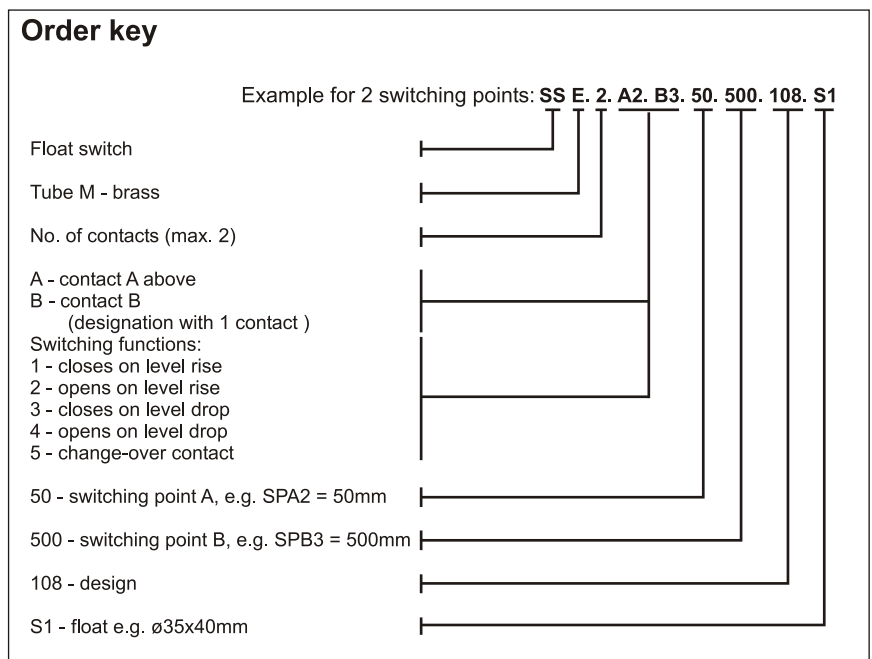
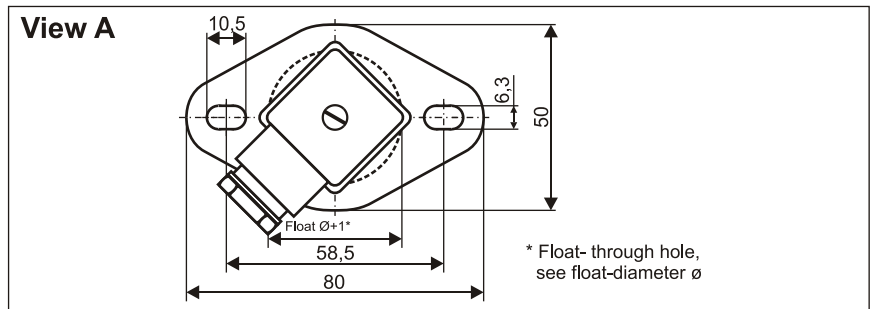
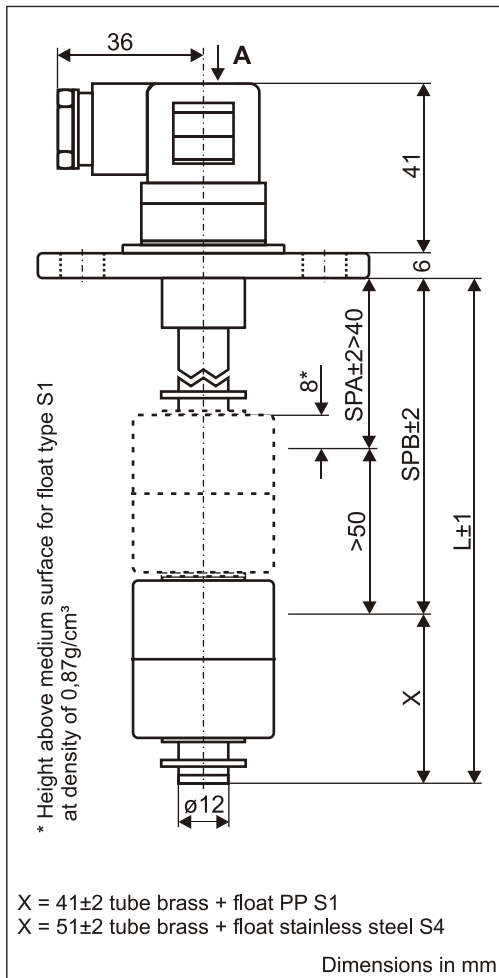

Technical data

Connection:	plug-type connector 3-polig + PE acc. to DIN EN 175301-803 (DIN 43650) material PA, cable entry M16x1.5
Mounting:	oval flange 80x50mm with slot hole, material PA
Seal:	material NBR
Tube:	ø12mm, material brass
Circlip:	material bronze
Float:	ø35x40mm material PP, type S1 ø45x52mm material stainless steel 1.4571, type S4
Switching points:	reed contacts: max. 2x n.o. contacts / n.c. contacts; 1x change-over contact
Switching capacity:	230VAC / 1A / 60VA
Pressure:	atmospheric
Operating temperature:	-20°C to 80°C in medium; -20°C to 70°C above mounting
Protection rating:	IP 65