

Rotary Cylinder

RHU-20,34,40,40N

Character

- Rotary unit of rack & pinion type with internal dual piston
- Identical stop power with a rotation power reduce rotation moment of inertia
- Integrated bracket to use a shoulder bolt key reduce the tolerance of end position
- In case of mounting with series AF30 or AF46, AF56N easy to assemble into a module
- Back side supply port prevent to twist of the power supply tube



Finger attachable swivel unit

Shock absorber

adjustable end rotary driving absorbency

Kinetic

pinion/toothed rack system for low tolerance transmission of drive power in one rotation movement

Body

high-tensile aluminum body with lightest possible because of hard anodizing

Mounting block

mounting for inductive proximity switch

Drive

double acting pneumatic cylinder

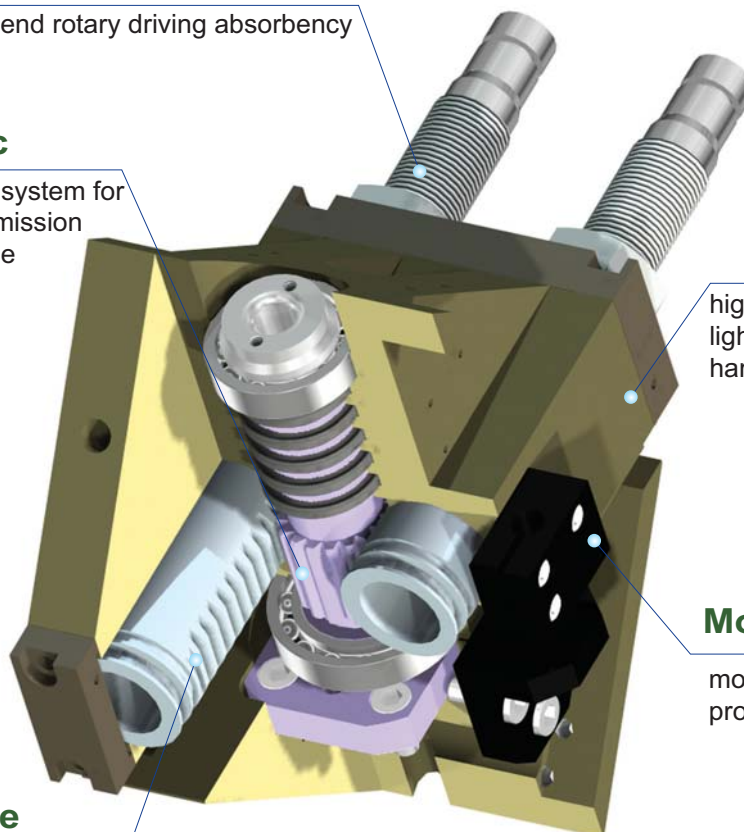

RHU

Exploded view

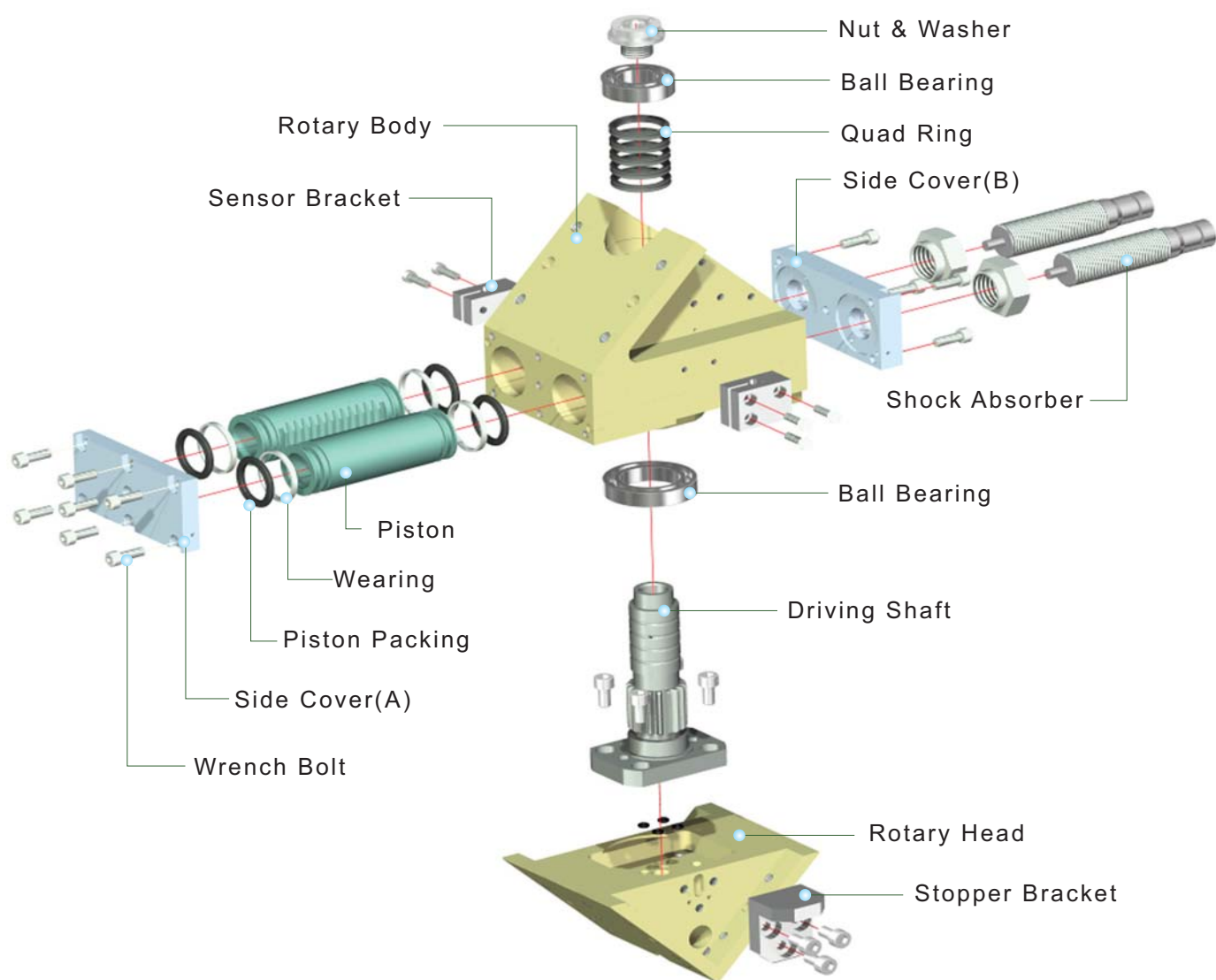

RHU

Ordering Code

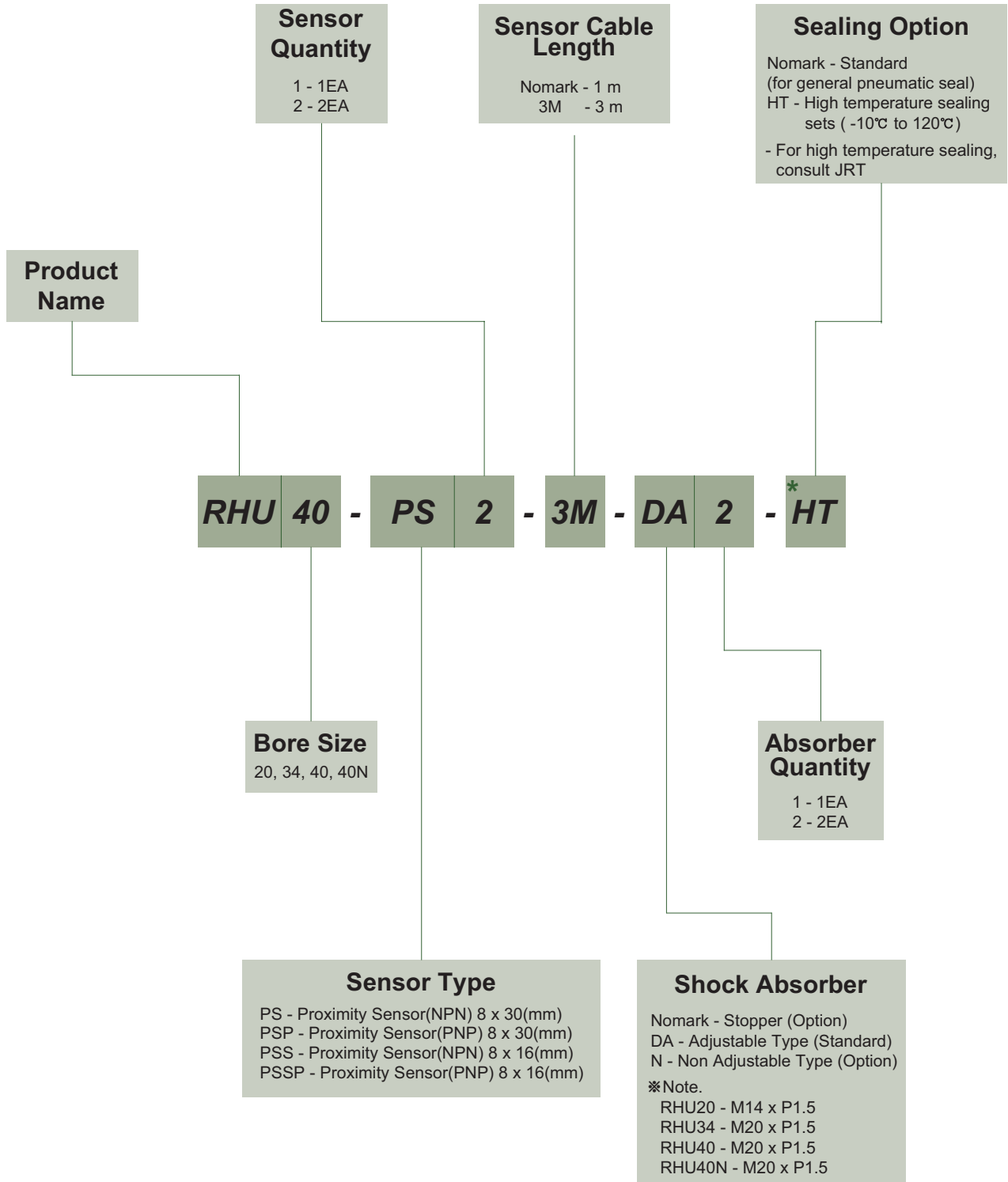

The delivery of * mark option is longer than a standard, So inquire of JRT

RHU

Specification

P=Air Pressure[bar]

Products Name	RHU20	RHU34	RHU40	RHU40N	Unit
Actual Torque	0.51P	1.274P	1.568P	3.018P	N.m
Radial payload	12	18	20	24	kg
Compress load(thrust)	10	13	15	21	kg
Tensile load(thrust)	10	13	15	21	kg
Weight	2.31	4.08	6.84	8.84	kg
Turning Time	0.3 to 1.0	0.4 to 1.2	0.5 to 1.5	0.8 to 2.0	sec
Fitting size	M5	M5,PF(G) 1/8	PF(G) 1/8	PF(G) 1/8	
Air consumption quantity	47.4	119.9	151.0	276.4	cm ³
Cushion	Absorber				
Repetition Accuracy	±0.1				degree
Operating pressure	3 to 7				bar
Ambient temperature	-5 to 60				°C
Lubrication	Needless				

* After 100 consecutive strokes to end positions

Note

RHU

RHU-20

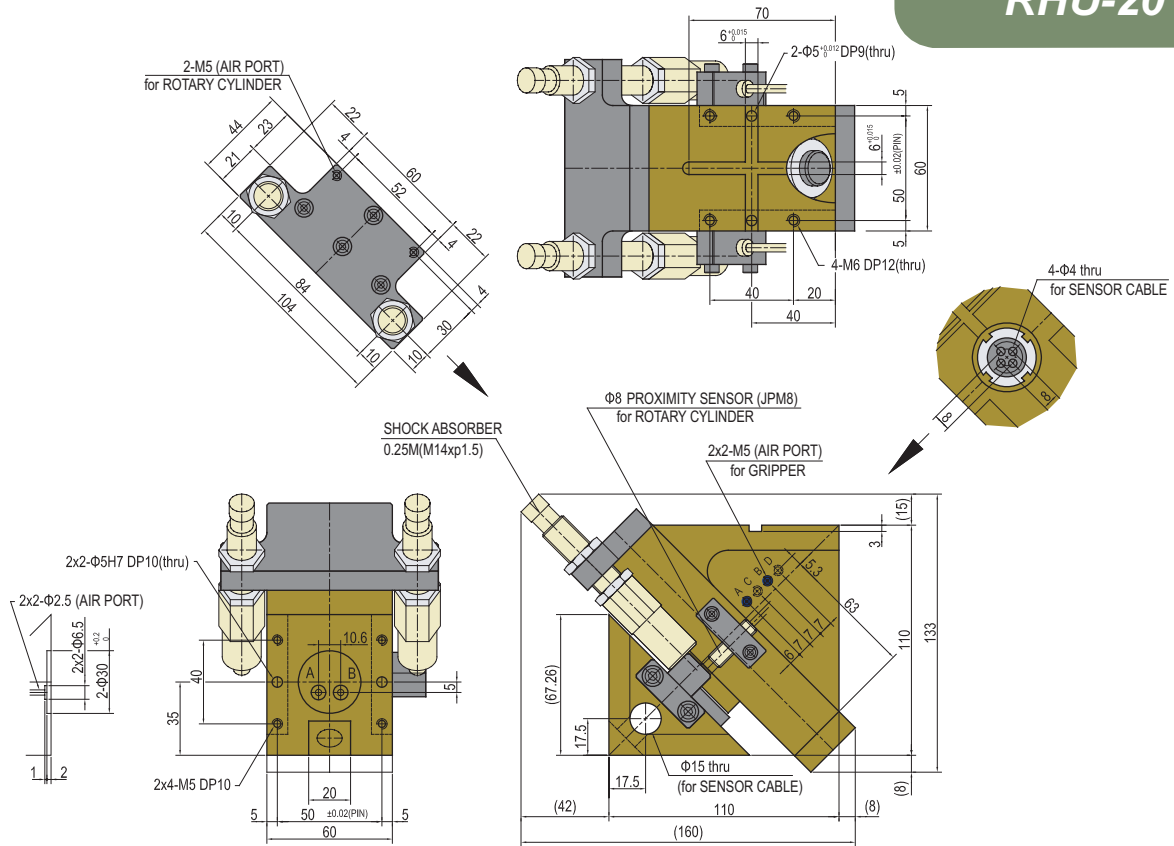

RHU-34

